

Feuerfeste Schottabdichtung • A – 60 Zulassung • 50 – 500 mm
Fireproof Bulkhead Seal • A – 60 Approval • 50 – 500 mm



Technische Merkmale:

- Feuerfest A-60, wasserdicht
- Baumustergeprüft : IMO 2010 FTP Code, Part 3 + MSC85/26 Add.1
- Typ-Zulassung durch DNV GL
- Einfache Montage durch geteilte Gehäuse und geteilte Dichtringe
- Elektrische Trennung zwischen Welle und Schott (keine Beeinflussung des Kathoden-Schutzsystems)
- Ausgelegt für hohe Gleitgeschwindigkeiten
- Radiale Beweglichkeit: +/- 5 mm

Einsatzgrenzen:

| | |
|-----------------------|-------------------|
| Wellendurchmesser: | 50 bis 500 mm |
| Temperatur: | - 5° bis + 950° C |
| Druck: | max. 2 bar |
| Gleitgeschwindigkeit: | max. 40 m/s |

Technical Features:

- Fireproof A-60, watertight
- Type-Approval test:
Per IMO 2010 FTP Code, Part 3 + MSC85/26 Add.1
- Type-Approval by DNV GL
- Easy installation due to split housings and split seal rings
- Electrical Insulation between shaft and bulkhead (no interference with the cathodic protection system)
- Developed for high shaft speed
- Allowed radial shaft movement: +/- 5 mm

Operating Limits:

| | |
|---------------------|-----------------|
| Shaft diameter: | 50 to 500 mm |
| Temperature: | -5° to + 950° C |
| Operating pressure: | max. 2 bar |
| Gliding speed: | max. 40 m/s |

Fireproof Bulkhead Seal 50 - 500 mm

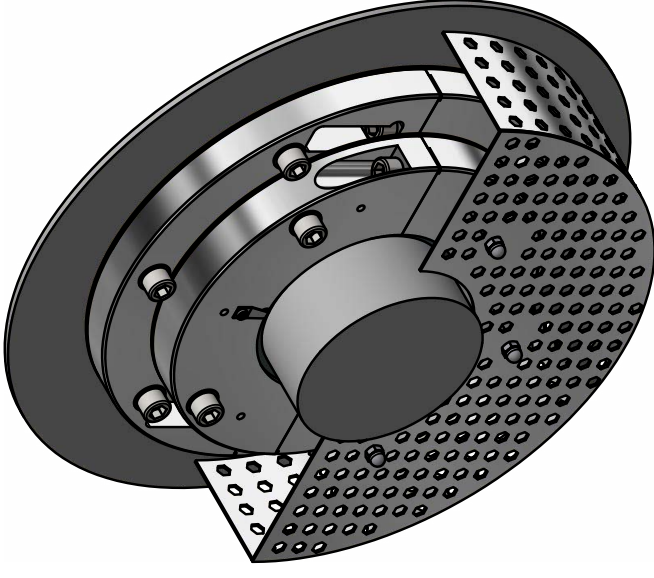
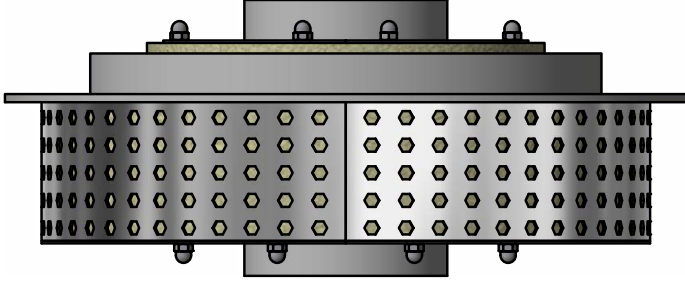
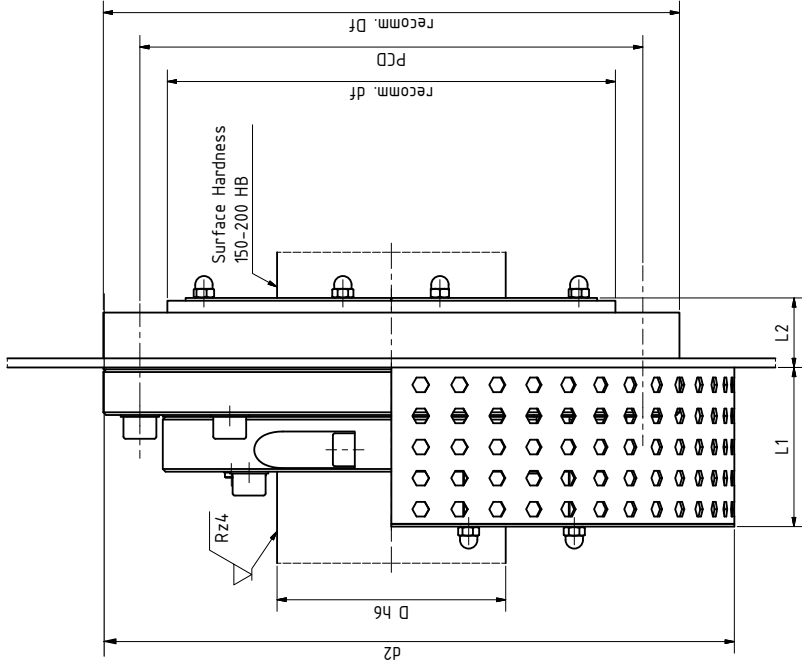

Exemplified dimensions (mm)

| D | d2 | PCD | df | Df |
|-----|-----|-----|-----|-----|
| 50 | 300 | 200 | 170 | 240 |
| 80 | 330 | 230 | 200 | 270 |
| 100 | 350 | 250 | 220 | 290 |
| 110 | 360 | 260 | 230 | 300 |
| 120 | 370 | 270 | 240 | 310 |
| 150 | 400 | 300 | 270 | 340 |

| D | d2 | PCD | df | Df |
|-----|-----|-----|-----|-----|
| 180 | 430 | 330 | 300 | 370 |
| 200 | 450 | 350 | 320 | 390 |
| 220 | 470 | 370 | 340 | 410 |
| 240 | 490 | 390 | 360 | 430 |
| 280 | 530 | 430 | 400 | 470 |
| 300 | 550 | 450 | 420 | 490 |

| D | d2 | PCD | df | Df |
|-----|-----|-----|-----|-----|
| 340 | 590 | 490 | 460 | 530 |
| 400 | 650 | 550 | 520 | 590 |
| 450 | 700 | 600 | 570 | 640 |
| 500 | 750 | 650 | 620 | 690 |

Other shaft sizes (D). Imperial sizes as well as detailed drawings for project application available on request. We reserve the right to change data and dimension without prior notice.